

Animal Feed Milling

Batch-Type Single Shaft Mixers WBH

35

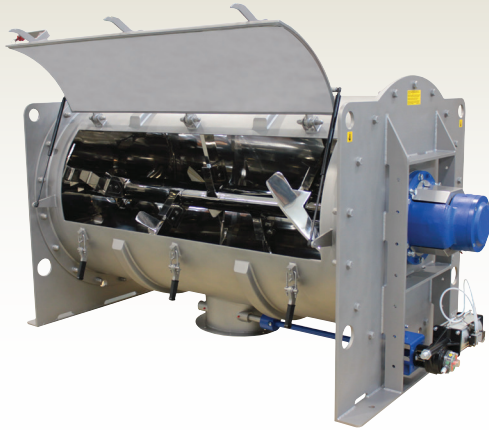

Description ▼

Batch-type WBH Single Shaft Mixers consist of a horizontal single shaft, equipped with ploughshare or shovel tools, housed in a tubular mixing drum. One or more inlets, an outlet with central discharge port, a venting spout, two drum closing end plates that carry flanged end bearing assemblies complete with integrated, adjustable shaft sealing unit and a drive unit complete with power transmission.

Function ▼

The horizontal single shaft ploughshare mixer WBH is based on the principle of mechanical fluidisation of the product. The particular shape, position and rotation speed of the mixing tools, create a centrifugal vortex motion, which allows the products to be projected in a three-dimensional way and to merge with each other. This ensures that components with different particle size and bulk density are perfectly blended and mixed with high precision within the shortest possible time.



Application ▼

For mixing different types of materials:

- Mash
- Meals
- Salt Lick and Minerals
- Milk Replacer
- Pet Food
- Fish Food
- Animal Care
- Feed Additives
- Veterinary products
- Animal Feed products in general

Benefits ▼

- ✓ **CV < 5%;**
- ✓ **Maximum mixing homogeneity;**
- ✓ **High-speed mixing;**
- ✓ **Low material residue;**
- ✓ **Minimum wear;**
- ✓ **Easy access to all internal parts;**
- ✓ **Top quality mixing;**
- ✓ **Low maintenance;**
- ✓ **Attractive price.**

Animal Feed Milling

Batch-Type Single Shaft Mixers WBH



Technical Features / Performance ▼

- ▶ From 75 up to 15,000 litres volume
- ▶ Different construction materials
- ▶ Choppers and liquid injection
- ▶ Great variety of accessories and options available

Overall Dimensions ▼

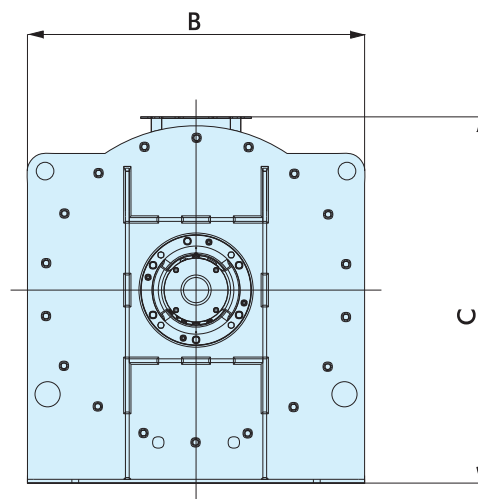
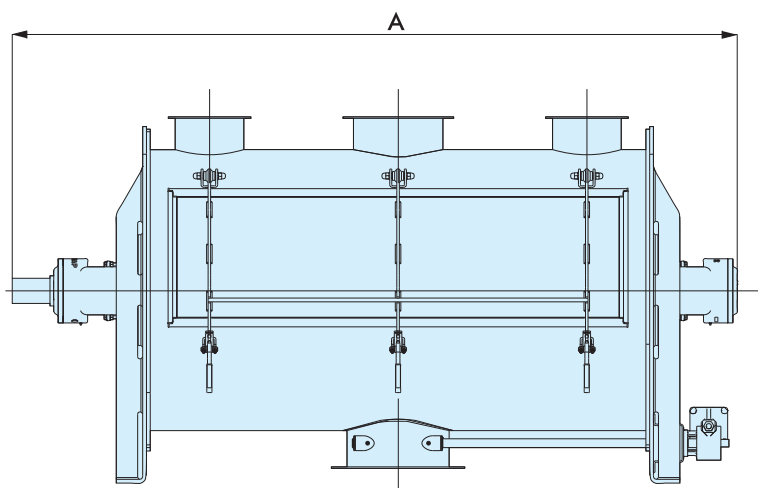

	A	B	C	Working Capacity (l)	Empty Weight (kg)
WBHV 75	1,300	611	649	21 - 55	245
WBHV 150	1,460	670	754	40 - 105	350
WBHV 300	1,840	770	889	85 - 210	550
WBHV 550	2,150	930	1,075	155 - 385	840
WBHV 800	2,350	980	1,151	215 - 560	1,080
WBHV 1100	2,690	1,100	1,278	315 - 770	1,400
WBHV 1600	2,690	1,100	1,278	485 - 1,150	1,400
WBHV 2000	2,920	1,340	1,455	551 - 1,400	2,100
WBHV 3000	3,920	1,340	1,455	825 - 2,100	2,800
WBHV 4800	4,520	1,500	1,750	1,340 - 3,360	4,300
WBHV 6000	4,820	1,600	1,860	1,650 - 4,150	4,800
WBHV 8800	5,390	1,810	2,130	2,450 - 6,150	5,800
WBHV 10500	5,630	1,910	2,160	2,950 - 7,350	6,900
WBHV 15000	6,124	2,110	2,445	4,100 - 10,500	8,200
WBHV 20000	6,617	2,312	2,665	6,000 - 14,000	11,903
WBHV 25000	6,888	2,432	2,735	7,500 - 17,500	13,653

Dimensions in mm

DS.220.WBH-EN-March2012.000 Rights reserved to modify technical specifications.